



TOM: Melbourne

## Speech Stand

### Use Instructions

rev V03

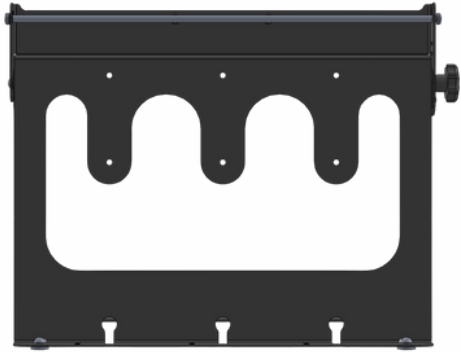

### Intended Use

Intended to be used to hold A4 and A5 Communication Books (PODD books), or other spiral bound books so they don't have to be supported by hand during use.

The stand can be used on a bench/desk surface or can have an adapter plate attached, allowing the stand to be attached to a mount (not provided).

The stand is intended to be used by adults and children above the age of 3 years.

This product is not a toy.

## ! Important Safety Information

### WARNING:

- Choking hazard: Not suitable for children under 3 years of age. Contains small parts.
- Adult supervision is recommended when this product is used by children.

It is recommended that suitability of this device and correct setup for individual circumstances be discussed with a health professional.

If this device is used with a mounting system, please be sure to follow manufacturers instructions and be sure to adhere to any specified weight limits for the mounting system.

Some assembly may be required. All assembly must be performed by an adult.

## Configurations

### For landscape books



### For portrait books

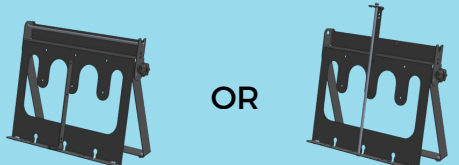

## Setting up the stand

If you have purchased the standard landscape version, no additional setup is required.

For use with portrait books you will need to attach the additional **Portrait Adapter** in your desired configuration A4 or A5:

**Assembly steps must be performed by an adult.**

### For A5 Books:

- 1 Position the Portrait Adapter in the desired location. This will be where the centre of the book is secured.

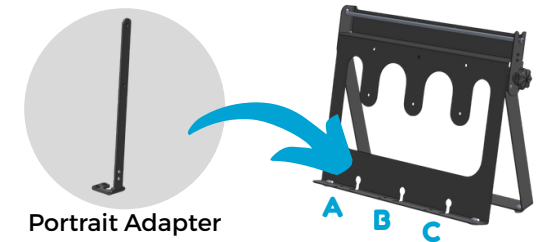

- 2 Use the provided allen key to firmly secure the Portrait Adapter with the provided 2 screws.

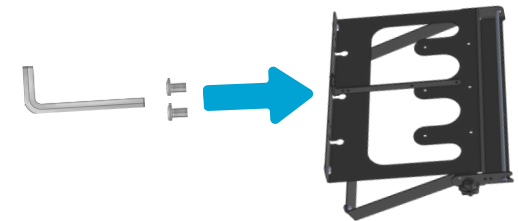

### For A4 Books:

- 1 Position the Portrait Adapter in the desired location. This will be where the centre of the book is secured. Use the allen key to firmly secure in place with the 2 screws provided.

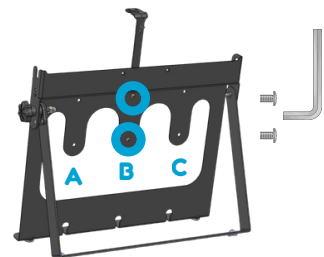

## Setting up the stand cont'd

- 2 Remove the Rod from the horizontal mounting position.

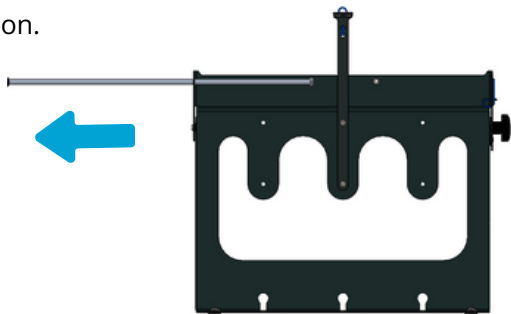

- 3 Insert Rod (end without washer) in key shape. Rotate upwards and secure top of rod with elastic.

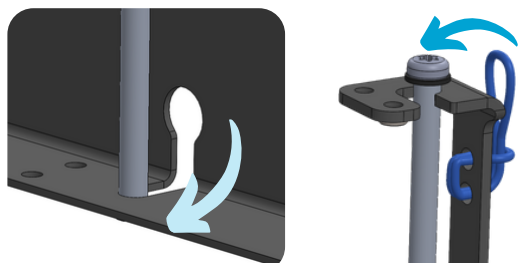

## Maintenance

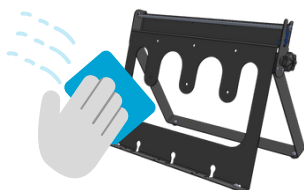

- Wipe with a damp cloth and all purpose cleaner.
- Regularly check Portrait Adapter screws are tight (if adapter in use).
- Avoid use of harsh chemicals.
- Avoid exposure to high heat (e.g. hot car) as damage may occur.

## Attaching a Communication Book

### Portrait Books



### Landscape Books



OR

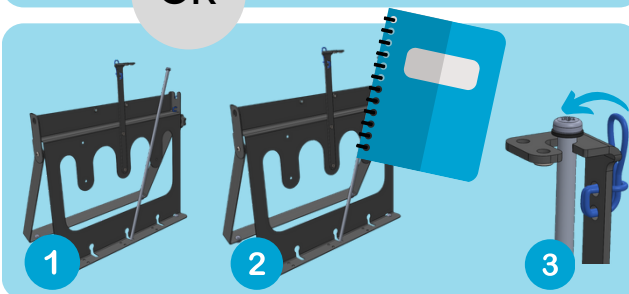

## Adjusting the stand angle

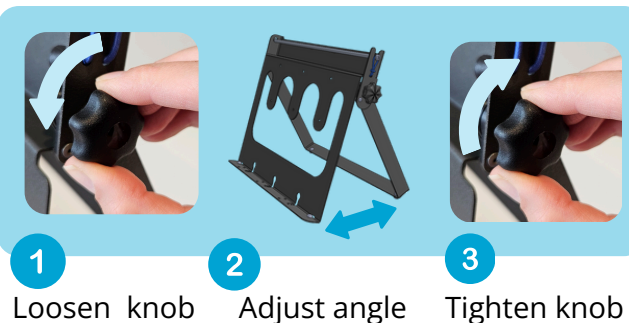

1

Loosen knob

2

Adjust angle

3

Tighten knob

## Attaching to mounting system

The stand can be attached to a mounting system (not supplied). An adapter plate can be attached via the two M4 threaded mounting holes. These are 75mm (VESA) spaced holes.

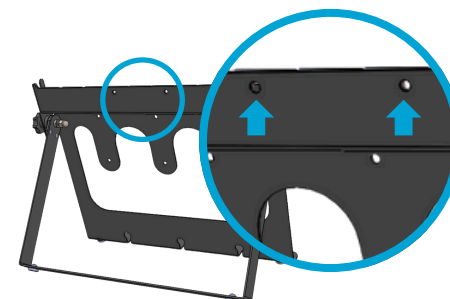

Seek health professional advice on suitability of use of mounting system. Please always follow mounting system manufacturers installation and use instructions, including guidelines for weight limits.

Shown right: TD I-110 Rehadapt & Daessy mount plate (reversible)

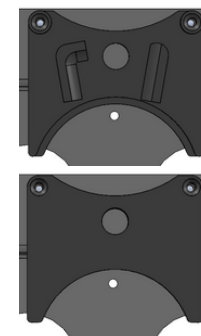

## Designed with the Community, for the Community.

This product was co-designed by TOM Melbourne in collaboration with our Need-Knowers community, including communication book users. We'd love to hear your feedback and experiences using it!

TOM: Melbourne also hosts a growing library of custom, open-source assistive technology—designed with people who have lived experience of disability. Explore the designs at [tommelmelbourne.org](http://tommelmelbourne.org), and if you have a need for custom assistive tech, we'd love to hear from you.

**email:** [info@tommelmelbourne.com.au](mailto:info@tommelmelbourne.com.au)

Designed & made in Australia